

AC REMOTE GEN 2 OWNERS MANUAL

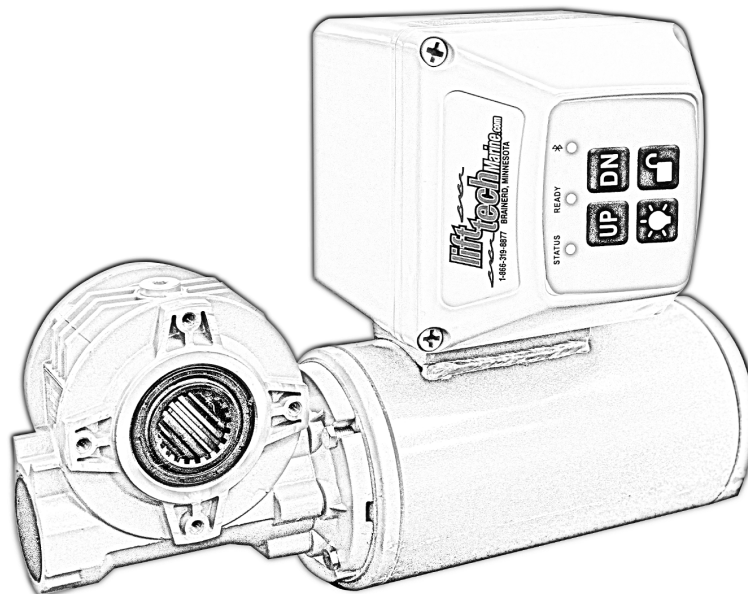

WWW.LIFTTECHMARINE.COM

Operating the AC Motor:

When the lift is going “up” the gear head should be going clockwise. When the lift is going “down” the gear head should be going counterclockwise. If it’s the opposite direction this means your lift was let down too far and is backwound. To fix this, let the lift down, when it runs out of cable it will wind itself up correctly and start going up.

Control Panel:

The control panel works the same as the remote controls. Press UP to go up and DN to go down. Press the light button to turn the canopy light on or off. When plugged into power the READY light will be a solid green and the Bluetooth symbol will blink blue. When you pair a phone through bluetooth the light will be a solid blue and no longer flash. The STATUS light will turn solid red when any button is pushed. If the remotes work and the control panel doesn't or vice versa, unplug the unit from power for 2 minutes. Hold the lock/unlock button until the LED lights start to blink together. When the control panel is locked the lights will blink for a set amount of time and then go out. To unlock the control panel hold the lock/unlock button until the LED lights stop blinking. The Bluetooth App will still work when the control panel is locked. The control panel and the remote controls will not work when locked. **If the control panel is locked the lights will flash when you press any button.**

Remotes and Bluetooth:

The two blue remote controls that come with the unit are already paired. You can download the phone app and control your motor with your phone. See the included Bluetooth instructions.

Off-Season Storage:

We recommend our storage cover for your motor if you are going to leave it sit outside during the winter months. Our storage cover will breathe and let moisture out while you're not using your motor.

Power Outage:

In case of a power outage, use the provided back up bit (inside floatie) on the end of the shaft with your drill. Visit our website to watch a video on how to use the back up bit.

Power Requirements for AC:

All power used on your dock or lift needs to be GFI Protected at the shoreline. Extension Cords must be 12/3 and under 150 feet. Circuit Breaker 20 AMPS GFI.

Maintenance:

Our motors are self-lubricating and do not need any maintenance.

Canopy Lights:

We offer Canopy lights that can plug into your unit and are controlled by the remotes. If you use a different brand of canopy lights they might not work. Our canopy lights will automatically shut off at 7 minutes.

Website:

Go to www.lifttechmarine.com for more information, troubleshooting and how to videos.

We would like to take this opportunity to say thank you. We value you, as a customer. Should you ever have an issue please give us a call at 218-454-0682 or send us an email at customerservice@lifttechmarine.com

CONNECTING TO IPHONE BY BLUETOOTH

***If your neighbors have a Lift Tech Marine unit make sure they are not using their lift while you are programming.* The app will not work if the Iphone has Dark Mode enabled.**

1. Go to the App store and search for Lift Tech and download the app. Once the app is downloaded on your phone, open the app and continue.
2. To activate the Bluetooth pairing sequence hold the UP and DN buttons on the control panel at the same time until the blue LED light turns solid. (See picture below). You will have around 15 seconds to add your phone. If the blue LED starts to blink, repeat the steps.



3. After you have activated the bluetooth sequence look at your phone and Tap the  button in the upper right hand corner of app. (See pic 2) LiftTech should now appear like in (pic 3). Tap on the Lift Tech Signal Strength and the screen should now look like (pic 4). Now tap on the pair option.
4. Once paired and connected to a Lift Tech receiver, the screen similar to (pic 5) will show the remote control options.
5. To rename your lift tap on Rename in the top right corner of the phone app.

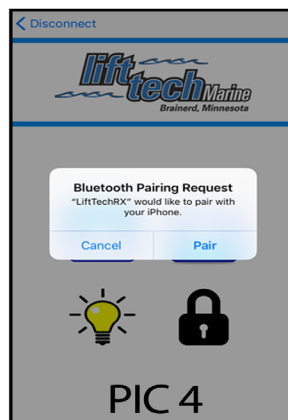
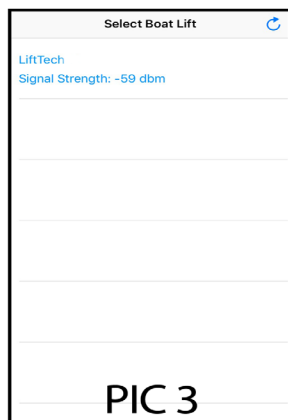
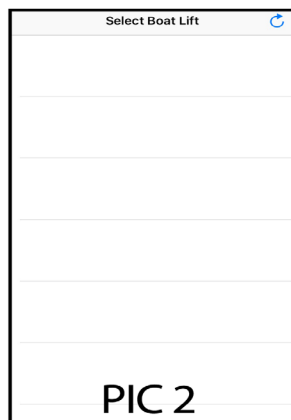

6. **UP.....** Pressing and holding this button will raise the lift.
DOWN.... Pressing and holding this button will lower the lift.
LIGHT..... Pressing this button will turn your canopy light on or off.
LOCK/UNLOCK..... Hold button until the lights start flashing to lock the control panel and remote controls. If locked hold until lights stop flashing to unlock.

Tap <disconnect in the upper left corner to save battery life on phone.

CONNECTING TO ANDROID BY BLUETOOTH

If your neighbors have a Lift Tech Marine unit make sure they are not using their lift while you are programming.

1. Go to Google Play and search for Lift Tech Marine and download the app. Once installed open the app.

2. To activate the Bluetooth pairing sequence hold the UP and DN buttons on the control panel at the same time until the blue LED light turns solid. (See picture below). You will have around 15 seconds to add your phone. If the blue LED starts to blink, repeat the steps.

3. Press the scan button on the top right of your phone. (See PIC 1)

4. When the phone finds the motor it will look like PIC 2.



5. Press on the Lift - Signal Strength that comes up on the phone to pair it.

6. Once the phone is paired it will look like PIC 3. You are now done pairing your phone with the control panel. If you want to rename your lift simply press the rename tab on the top right of the app and a box will come up like in PIC 4. Rename it to what you want and hit Rename to save it.



PIC 1



PIC 2

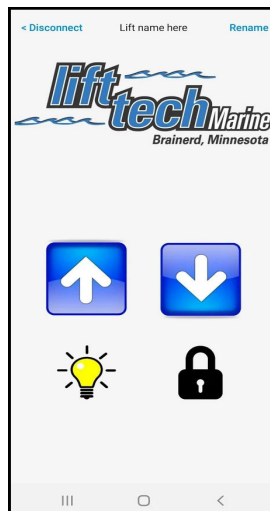

PIC 3

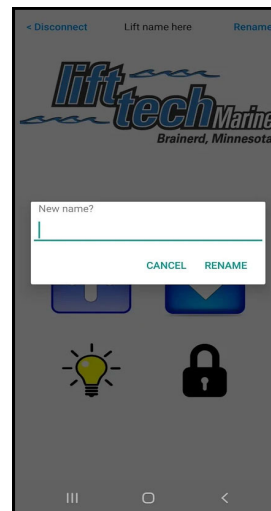

PIC 4

7. **UP.....** Pressing and holding this button will raise the lift.
DOWN..... Pressing and holding this button will lower the lift.
LIGHT..... Pressing this button will turn your canopy light on or off.
LOCK/UNLOCK..... Hold button until the lights start flashing to lock the control panel and remote controls. If locked hold until lights stop flashing to unlock.

Optional Pendant for AC and DC Manual Motors Only:

Comes with 15 feet of wire and plugs directly into the control box. The control box is already wired for it. Just remove the small black nipple cap. Key is not required when using pendant.



PENDANT

Optional Canopy Light for AC/DC Remote and Autostop Motors Only:

Five feet of Super Bright White LED Lights. Can turn on and off with control panel or remote controls. Will automatically shut off at 7 minutes.



CANOPY LIGHTS

Storage Cover:

We recommend our storage cover for your motor if you are going to leave it sit outside during the winter months. Our storage cover will breathe and let out moisture.



OPTIONAL STORAGE COVER

Recommended Hard Plastic Cover:

Helps protect the motor all summer long from rain and other elements. Covers up the spinning gear head for extra safety. Back of cover is left open so it doesn't create condensation. Cover fits Vertical and Horizontal units. Will not fit the PWC or Wheel Drive motor.

RECOMMENDED HARD COVER



Plastic Battery Boxes for DC Units Only.

Plastic battery box that will fit Group 24 and 27 series deep cycle batteries. If your battery leaks for any reason, it will help protect the boat from getting battery acid on it.

Optional Battery Boxes



Charge Control Regulators For DC Units Only.

Perfect to keep your batteries from being over charged. Over charged batteries can lead to problems and possible battery explosion.



OLD STYLE PLUGIN



NEW STYLE PLUGIN



Warranty Card

***Must be filled out and sent to us within 60 days of purchase along with a copy of the original receipt for warranty to be valid.**

CIRCLE PRODUCT PURCHASED:

AC-PWC DC-PWC AC-WHEEL DRIVE DC-WHEEL DRIVE AC MANUAL DC MANUAL

AC REMOTE DC REMOTE AC AUTOSTOP DC AUTOSTOP

WINCHBOX AC MANUAL WINCHBOX AC REMOTE WINCHBOX DC MANUAL

WINCHBOX DC REMOTE WINCHBOX AC AUTOSTOP WINCHBOX DC AUTOSTOP

PURCHASED FROM: _____

DATE OF PURCHASE: _____

NAME: _____

ADDRESS: _____

EMAIL: _____ PHONE: _____

LIFT TECH MARINE WARRANTS OUR MOTOR FROM DEFECTS IN MATERIALS AND WORKMANSHIP UNDER NORMAL USE FOR A PERIOD OF 2 YEARS FROM THE DATE OF PURCHASE. DURING THE WARRANTY PERIOD, LIFT TECH MARINE WILL REPAIR THE MOTOR IF DEFECTIVE. THE WARRANTY IS LIMITED TO THE PURCHASER AND IS NOT TRANSFERABLE. THIS WARRANTY IS VOID IF THE PRODUCT IS MODIFIED OR ALTERED BY ANYONE OTHER THAN LIFT TECH MARINE, LLC.

***ALL WARRANTY CARDS MUST BE FILLED OUT WITHIN THE TIME FRAME AND HAVE A COPY OF THE ORIGINAL PURCHASE RECEIPT TO BE VALID.**

SEND THIS FORM AND YOUR RECEIPT TO :
CUSTOMERSERVICE@LIFTTECHMARINE.COM
OR MAIL TO:
LIFT TECH MARINE
7958 HASTINGS ROAD
BAXTER, MN 56425

RECOMMENDED HARD COVER



FIND MORE INFORMATION ONLINE AT WWW.LIFTTECHMARINE.COM